

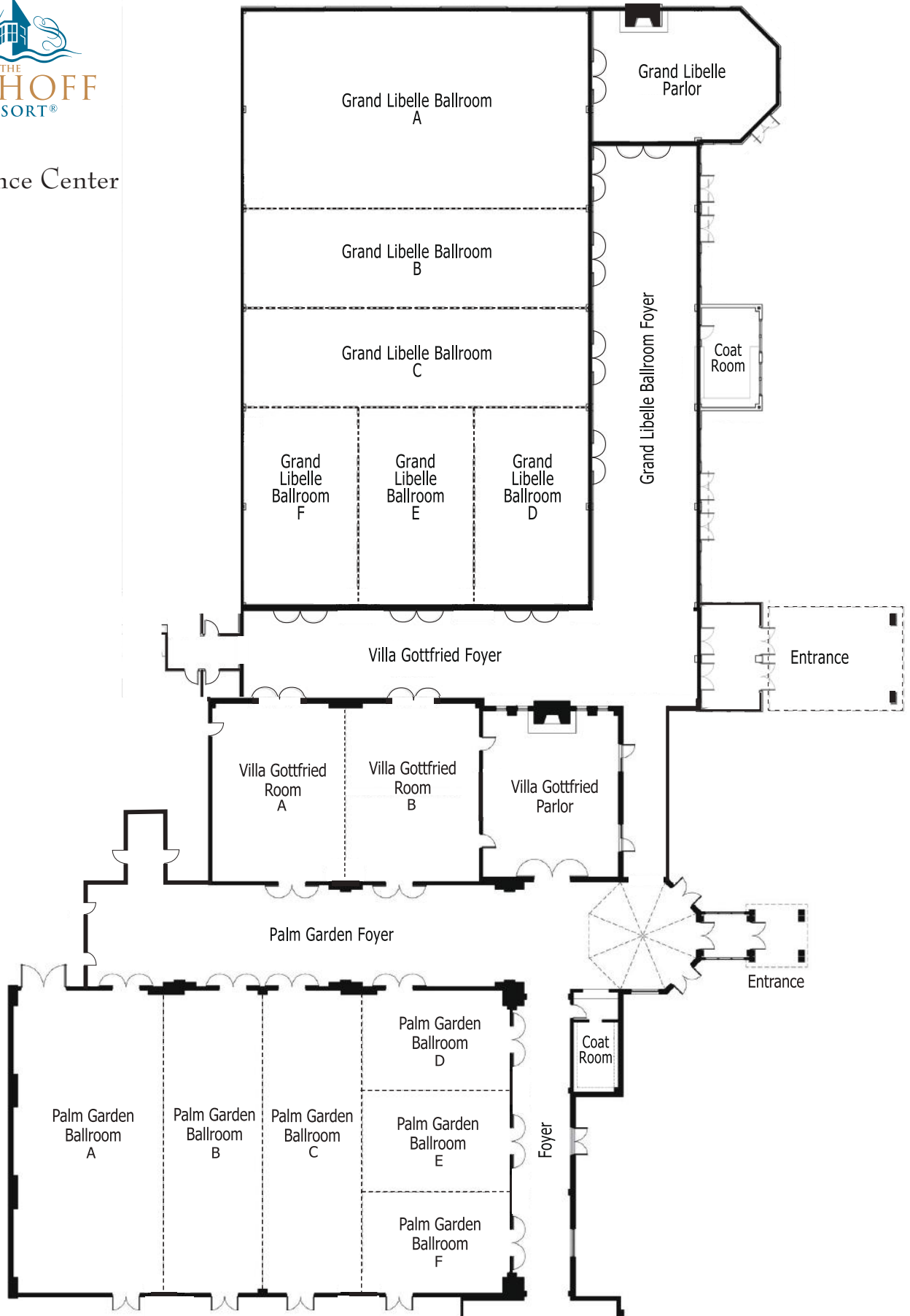

Conference Center





Conference Center

Room	Dimensions	Sq. Feet	Banquet	Classroom*	Theatre	U-Shape	Conference	Crescent Rounds**
Grand Libelle Ballroom	77' x 132'	10,164	800	600	1,200	---	---	560
Grand Libelle Ballroom A	77' x 44'	3,388	200	180	324	84	---	144
Grand Libelle Ballroom A & B	77' x 66'	5,082	300	240	540	---	---	210
Grand Libelle Ballroom B & C	77' x 44'	3,388	200	180	324	84	---	144
Grand Libelle Ballroom B	not an option alone							
Grand Libelle Ballroom C	not an option alone							
Grand Libelle Ballroom A-C	77' x 88'	6,776	480	360	864	---	---	330
Grand Libelle Ballroom B-F	77' x 88'	6,776	480	360	864	---	---	330
Grand Libelle Ballroom C-F	77' x 66'	5,082	300	240	540	---	---	210
Grand Libelle Ballroom D	25' 8" x 44'	1,129	60	56	80	35	30	42
Grand Libelle Ballroom E	25' 8" x 44'	1,129	60	56	80	35	30	42
Grand Libelle Ballroom F	25' 8" x 44'	1,129	60	56	80	55	30	42
Grand Libelle Ballroom D & E	51' 4" x 44'	2,258	120	110	180	55	---	96
Grand Libelle Ballroom E & F	51' 4" x 44'	2,258	120	110	180	55	---	96
Grand Libelle Ballroom D-F	77' x 44'	3,388	200	180	324	84	---	144
Grand Libelle Parlor	41' x 29' 2"	1,095						
Grand Libelle Ballroom Foyer	23' 4" x 103'	2,400						
Palm Garden Ballroom	68' x 110' 8"	7,526	600	500	1,000	---	---	420
Palm Garden Ballroom A	68' x 37'	2,516	180	150	240	56	---	120
Palm Garden Ballroom A & B	68' x 55' 4"	3,763	250	224	400	---	---	175
Palm Garden Ballroom B & C	68' x 37'	2,516	180	150	240	56	---	120
Palm Garden Ballroom B	not an option alone							
Palm Garden Ballroom C	not an option alone							
Palm Garden Ballroom A-C	68' x 74'	5,032	400	326	600	---	---	280
Palm Garden Ballroom B-F	68' x 74'	5,032	400	326	600	---	---	280
Palm Garden Ballroom C-F	68' x 55' 4"	3,763	250	224	400	---	---	175
Palm Garden Ballroom D	22' 8" x 37'	839	50	50	70	30	25	35
Palm Garden Ballroom E	22' 8" x 37'	839	50	50	70	30	25	35
Palm Garden Ballroom F	22' 8" x 37'	839	50	50	70	30	25	35
Palm Garden Ballroom D & E	45' 4" x 37'	1,677	100	96	140	46	---	70
Palm Garden Ballroom E & F	45' 4" x 37'	1,677	100	96	140	46	---	70
Palm Garden Ballroom D-F	68' x 37'	2,516	180	150	240	56	---	120
Palm Garden Foyer	110' x 22'	2,420						
Foyer	68' x 9'	612						
Villa Gottfried Room	40' x 60'	2,400	150	140	240	56	---	105
Villa Gottfried Room A	40' x 30'	1,200	70	60	110	32	30	49
Villa Gottfried Room B	40' x 30'	1,200	70	60	110	32	30	49
Villa Gottfried Parlor	31' x 37'	1,147						
Villa Gottfried Foyer	20' 3" x 101'	2,078						

*Classroom / U-Shape / Conference capacities represent 3 people per 6-ft table.

**Crescent Rounds represent 7 people per table.

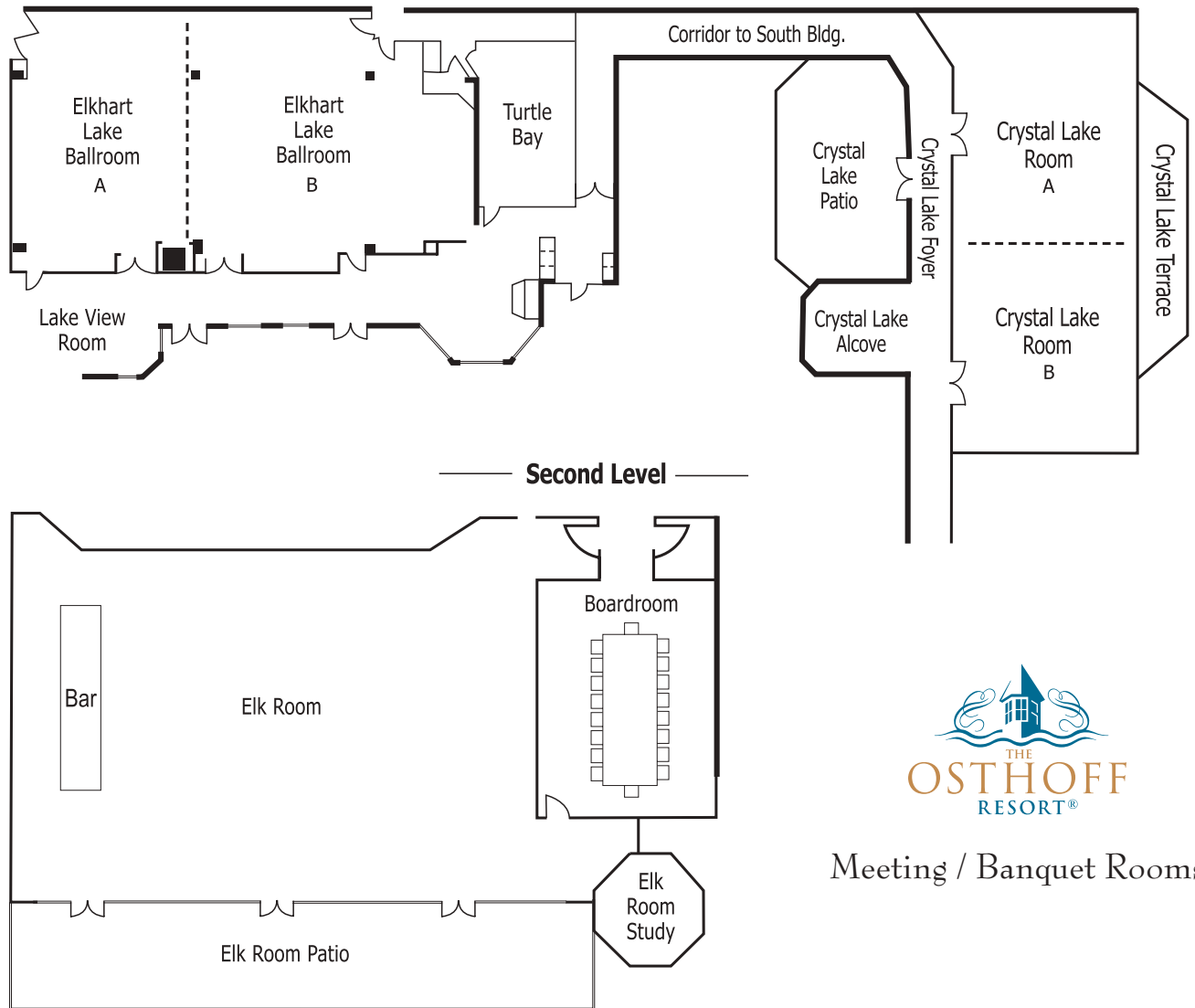

Meeting / Banquet Rooms

Room	Dimensions	Sq. Feet	Banquet	Classroom*	Theatre	U-Shape	Conference	Crescent Rds**
Elkhart Lake Ballroom	45' x 80'	3,600	200	180	260	---	---	126
Elkhart Lake Ballroom A	45' x 32'	1,440	60	60	90	28	36	36
Elkhart Lake Ballroom B	45' x 48'	2,160	150	110	140	35	---	98
Crystal Lake Room	32' x 50'	1,600	120	100	150	35	---	70
Crystal Lake Room A	32' x 50'	800	50	40	80	24	24	28
Crystal Lake Room B	32' x 25'	800	50	40	80	24	24	28
Turtle Bay	16' x 28'	448	30	24	30	15	20	---
Board Room	16' x 28'	448	---	---	---	---	16	---
Lake View Room	15' x 40'	600	50	---	---	---	---	---
Elk Room	42' x 48'	2,016	---	---	---	---	---	---
Osthoff Grounds / Gazebo	For setup and capacity information, contact an Osthoff Sales Representative.							
Premier Suites	For setup and capacity information, contact an Osthoff Sales Representative.							

*Classroom / U-Shape / Conference capacities represent 3 people per 6-ft table.

**Crescent Rounds represent 7 people per table.